

- Advanced Lithium Ion Technology
- Fully certified, Active Control Board built-in (BMS)
- Extra light weight; only 40% compared to lead acid batteries.
- Long Cycle Life of > 4000 cycles
- Maintenance free, direct replacement for lead acid batteries in all solar systems.



SPECIFICATION

ELECTRICAL CHARACTERISTICS	Nominal Voltage	12.8V
	Nominal Capacity	200Ah
	Energy	2560Wh
	Internal Resistance	≤20mΩ
	Cycle Life	> 4000 cycles
	Months Self Discharge	<3%
	Efficiency of Charge	100% @0.5C
	Efficiency of Discharge	96~99% @1C
STANDARD CHARGE	Charge Voltage	14.4V to 14.6V
	Charge Mode	0.2C to 14.6V, then 14.6V, charge current to 0.02C (CC/CV)
	Charger Current	60A
	Max. Charge Current	120A
	Automatic Over Voltage Cut-off	16V
STANDARD DISCHARGE	Maximum Continuous Discharge Current	125A
	Max. Pulse Current	140A(<3s)
	Automatic Low Voltage Cut-off	8V
ENVIRONMENTAL	Charge Temperature	-15°C to 65°C
	Discharge Temperature	-25°C to 80°C
	Storage Temperature	-15°C to 65°C
	Water Dust Resistance	IP56
MECHANICAL	Cell & Method	26650 4S64P
	Plastic Case	ABS
	Dimensions (in./mm.)	522*240*224mm (20.55"*9.45"*8.81")
	Weight (lbs./kg.)	(32.6kg) 72Lbs
	Terminal	M8
	Protocol (optional)	SMBus/RS485/RS232
	SOC (optional)	LED

CYCLE LIFE CURVE

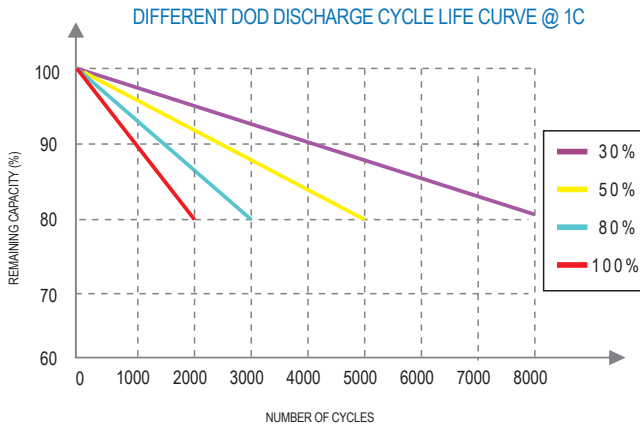

SELF-DISCHARGE CHARACTERISTICS CURVE

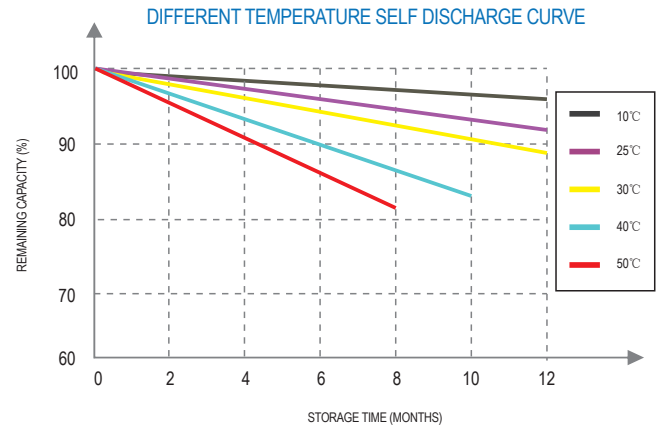

DIFFERENT RATE OF DISCHARGE CURVE

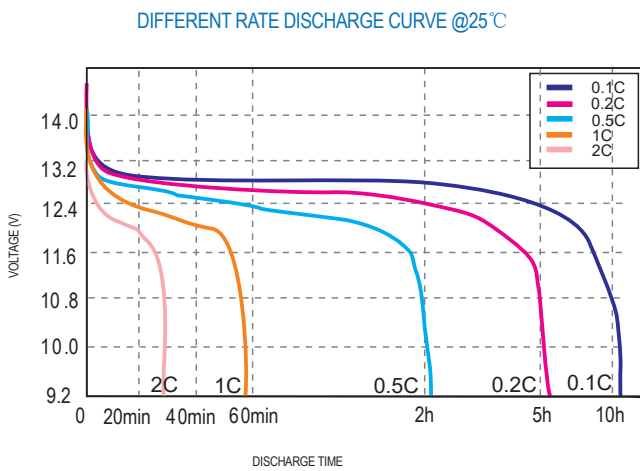

DIFFERENT TEMPERATURE DISCHARGE CURVE

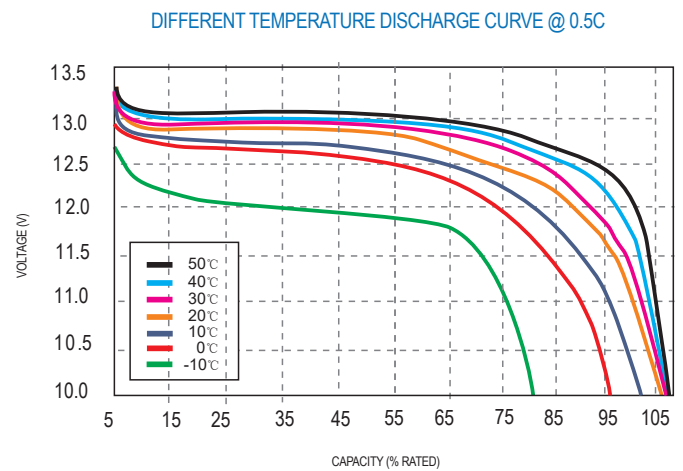

STATE OF CHARGE CURVE

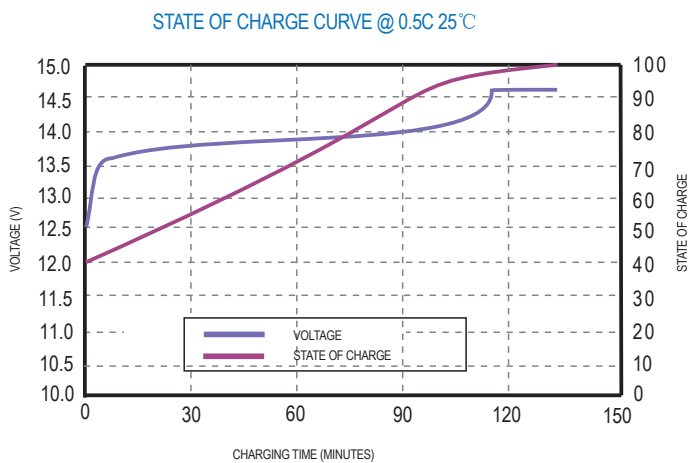

CHARGING CHARACTERISTICS

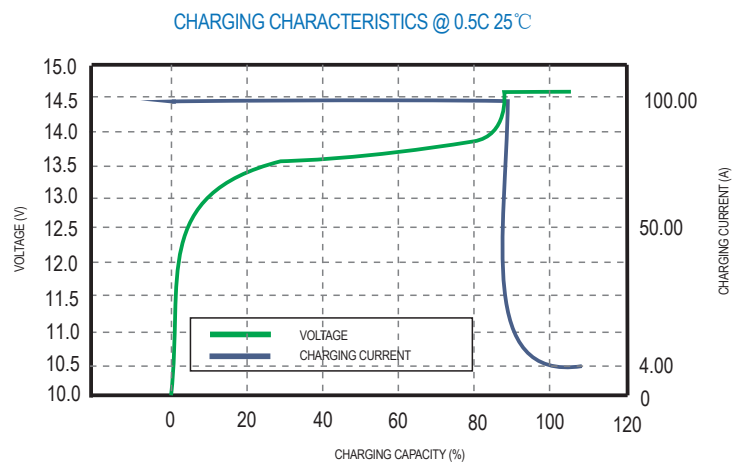

DIMENSIONS

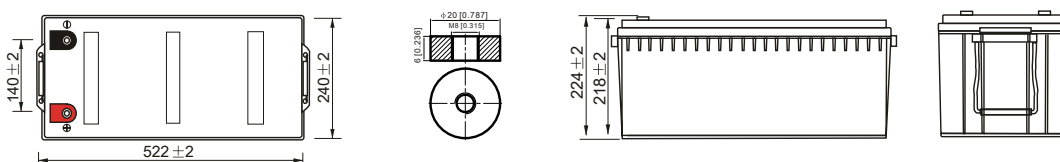

OUR PARTNER:



www.hollandiasolar.com